

Tear Sheet  
Model Phoenix on rose by KARCHER DESIGN

KARCHER  
DESIGN

GERMANY

contact our US office  
Karcher Design USA  
Tukwila, Seattle  
+1 844 858 2033  
order@karcher-design.com



**Phoenix**

Finish: chrome/satin nickel (65)

**To suit standard 2 1/8" door prep**

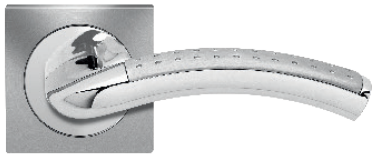

**Phoenix- UR 40Q**  
2 5/8 x 2 5/8 x 7/16"



**Phoenix- UR 40**  
Ø 2 5/8 x 7/16"

**Features UR40Q and UR40**

- 3 piece rose
- concealed bolt-through fixing
- sprung
- door range 1 1/4" (31 mm) - 2" (51 mm) standard
- T- and Lip-Strike with dust box
- stainless steel faceplate
- backsets: 2 3/8" (60 mm) or 2 3/4" (70 mm)
- functions: Passage (PAS), Privacy (PRI), full dummy (DUM), dummy left (DUM L), dummy right (DUM R)
- available with UL-Latch
- 28° latch with attached face plate
- rate of satin stainless steel 304
- hub 5/16" (8 mm)
- door prep 2 1/8"
- available finish: chrome/satin nickel

**product code square**

UR40Q PAS60 65	passage 2 3/8" backset
UR40Q PAS70 65	passage 2 3/4" backset
UR40Q PRI60 65	privacy 2 3/8" backset
UR40Q PRI70 65	privacy 2 3/4" backset
UR40Q DUM 65	full dummy
UR40Q DUM L 65	half dummy left
UR40Q DUM R 65	half dummy right
UEDBQ 73	deadbolt to add to passage

**round**

UR40 PAS60 65	passage 2 3/8" backset
UR40 PAS70 65	passage 2 3/4" backset
UR40 PRI60 65	privacy 2 3/8" backset
UR40 PRI70 65	privacy 2 3/4" backset
UR40 DUM 65	full dummy
UR40 DUM L 65	half dummy left
UR40 DUM R 65	half dummy right
UEDB 73	deadbolt to add to passage
UEDBA 73	deadbolt keyed alike

**specification details**

**lever**

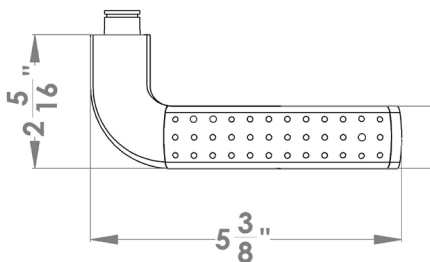

**round rose**

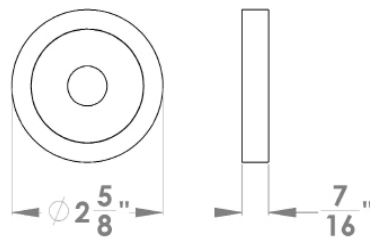

**square rose**

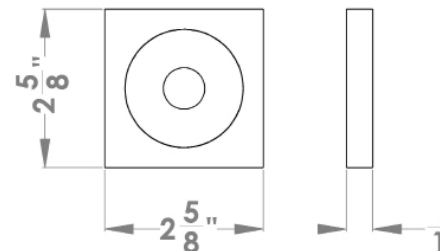

Please note: Karcher Design products are designed and measured in metric. Imperial measurements are close approximations to the actual metric dimensions